

# MARKETING SALES DRAWING

DIMENSIONS IN INCHES - DO NOT SCALE THIS DRAWING  
 DIMENSIONS IN METRIC [-]

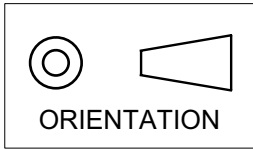

Electrical Testing  
 per Tusonix standard  
 test plans and Mil-Std-202  
 Test Methods.

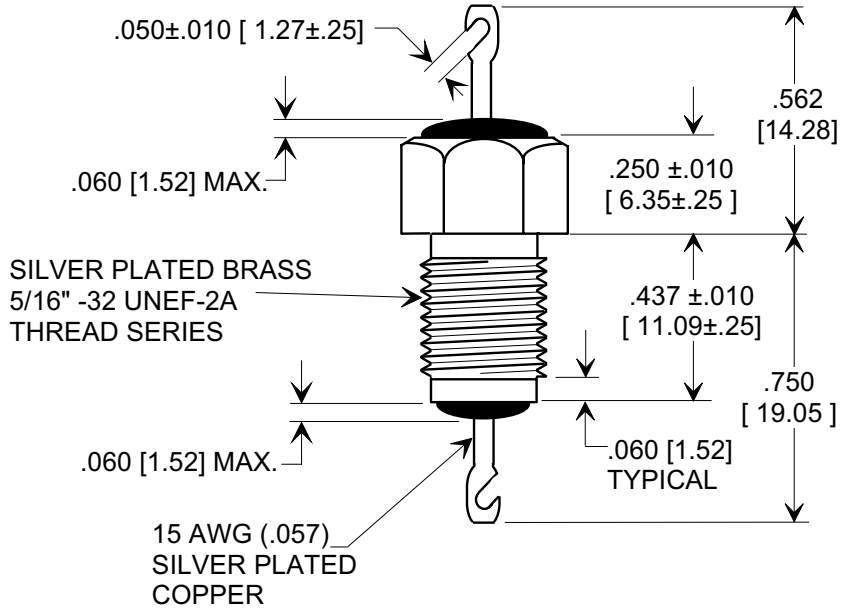
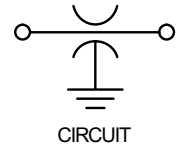
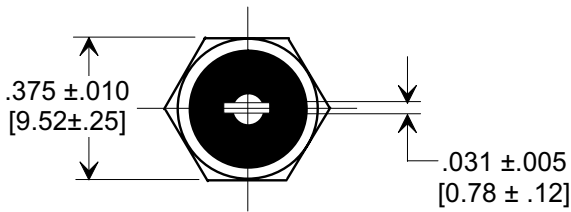

**NOTES:**

- TUSONIX STANDARD PART NUMBER: 4206-025.  
 TUSONIX RoHS COMPLIANT PART NUMBER: 4206-025 LF.  
 CUSTOMER MUST SPECIFY STANDARD OR RoHS PART NUMBER WHEN ORDERING.
- LEAD FINISH: SILVER PLATED COPPER SOLDER DIPPED. RoHS PARTS ARE DIPPED IN LF SOLDER.
- PART MARKING: TRADEMARK AND VARIATION NUMBER ON HEX FLATS.  
 STANDARD PART: BLACK INK. RoHS PART: GREEN INK.
- SUPPLIED WITH SILVER PLATED COPPER ALLOY HEX NUT AND INTERNAL TOOTH LOCKWASHER.

1500	± 20%	1000	500	25 A
CAP. (pF)	CAP. TOL.	85 °C	125 °C	CURRENT dc (A)
WORKING VOLTAGE DC (V)				

X-2015 Rev-0	REVISION RECORD				TOLERANCES unless otherwise specified 2 PLC. DECIMAL ± $\frac{\quad}{\quad}$ 3 PLC. DECIMAL ± $\frac{.031}{[.78]}$ ANGLES ± $\frac{\quad}{\quad}$	Title <b>BUSHING STYLE FEED-THRU CAPACITOR</b>		
	Original Release C.O.	WAS SK 7501-000 L.E. 05-16-00	0	1		Drawn L.E. 07-08-98		
	REVISED NOTES: S.M. 10-26-05					Approved H.R. 07-08-98		
	2000516-5-01					<b>TUSONIX</b> TUCSON, ARIZONA		
20051006-1-16				<b>A</b>		<b>4206-025</b>		